



# HID-Basic ballasts for HPL and HPI(PLUS) lamps

## BHL 250L 200

The HID-Basic ballast is an impregnated (HID standard) electromagnetic ballast for HID lamps, for use in combination with an external ignitor.

### Product data

General Information		Temperature	
Application code	L200	T-winding (max.)	130 °C
<b>Operating and Electrical</b>		Delta-T normal conditions	65 °C
Input Voltage	220 V	<b>Approval and Application</b>	
Input frequency	50 Hz	Approval marks	CE marking CCC certificate
Power factor 100% load (min.)	0.85	<b>Product Data</b>	
Mains voltage performance (AC)	-8%~+6%	Full product code	694818229965900
Mains voltage safety (AC)	-10%~+10%	Order product name	BHL 250L 200
Input current with PF correction	1.35 A	EAN/UPC – product	6948182295293
Input current without PF Correction	2.13 A	Order code	913710100442
Power factor without PF compensation (nom.)	0.55	SAP numerator – quantity per pack	1
Power losses (nom.)	17 W	Numerator – packs per outer box	6
<b>Wiring</b>		SAP material	913710100442
Connector type	Screw	SAP net weight (piece)	2.000 kg
<b>System characteristics</b>			
Rated ballast-lamp power	250 W		

## HID-Basic ballasts for HPL and HPI(PLUS) lamps

### Dimensional drawing

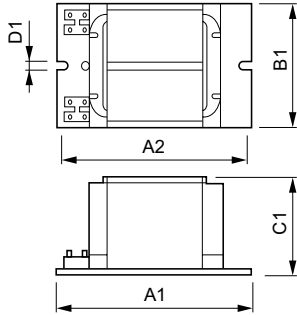

Product	D1	C1	A1	A2	B1
BHL 250L 200	6.2 mm	64.5 mm	125.0 mm	110.0 mm	75.5 mm

BHL 250 L200

